

# ELF 1

# Linear Guide Rail

## Features

- W 20 x H 31 mm
- Precision steel shaft Ø 12
- Aluminum shaft seat profile, nature anodized
- Attachment from the bottom by thread rails M6 in the T-grooves on an even surface
- Arbitrary Guide Rail length
- Weight: 1.26 kg/m

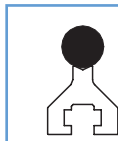

## with Roller Carriage LW 5

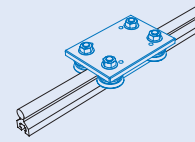

- L 110 x B 75 x H 7.7 mm
- Polished steel plate
- 4 rollers Ø 31, for-life lubrication
- Play-free adjustable
- Weight: 0.81 kg

## with Bearing Carriage WS 6

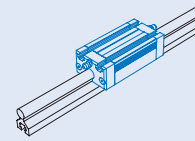

- L 100 x W 50 x H 31.5 mm
- T-grooves M6
- Central lubrication
- Play-free adjustable
- Weight: 0.30 kg
- **Option:** stainless version

## Load Data

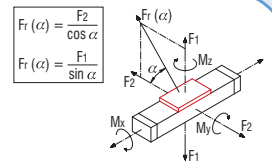

Roller Carriage LW 5		Bearing Carriage WS 6	
C <sub>0</sub>	2160 N	C <sub>0</sub>	3303 N
C	4000 N	C	1873 N
F <sub>1 stat.</sub>	4320 N	F <sub>1 stat.</sub>	2821 N
F <sub>1 dyn.</sub>	3846 N	F <sub>1 dyn.</sub>	1599 N
F <sub>2 stat.</sub>	2160 N	F <sub>2 stat.</sub>	3303 N
F <sub>2 dyn.</sub>	4000 N	F <sub>2 dyn.</sub>	1873 N
M <sub>x stat.</sub>	-	M <sub>x stat.</sub>	-
M <sub>x stat.</sub>	162.0 Nm	M <sub>x stat.</sub>	105.3 Nm
M <sub>y stat.</sub>	81.0 Nm	M <sub>y stat.</sub>	123.3 Nm
M <sub>x dyn.</sub>	-	M <sub>x dyn.</sub>	-
M <sub>x dyn.</sub>	144.2 Nm	M <sub>x dyn.</sub>	59.7 Nm
M <sub>z dyn.</sub>	150.0 Nm	M <sub>z dyn.</sub>	69.9 Nm

## Dimensioned Drawings

\* = available upon request

