

LF 2

Linear Guide Rail

Features

- W 62 x H 31 mm
- 2 precision steel shafts Ø 12
- Stiff against torsion
- Aluminum shaft seat profile, nature anodized
- High parallelism by patented shaft seat contour
- High guiding precision
- Attachment from the top or from below through holes Ø 6,5 in a 100 mm raster on an even surface
- Arbitrary Guide Rail length
- Weight: 3.29 kg/m



with Roller Carriage LW 3

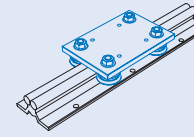

- L 125 x W 85 x H 7.7 mm
- Polished steel plate
- Weight: 0.93 kg

with Aluminum Bearing Carriage WS 4

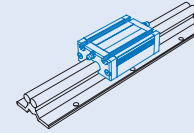

- L 94 x W 62 x H 31.5 mm
- Milled clamping surface
- Weight: 0.33 kg
- **Option:** stainless version

with Steel Bearing Carriage LS 1

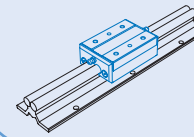

- L 91 x W 60 x H 32 mm
- Polished clamping surface
- Weight: 0.80 kg

Load Data

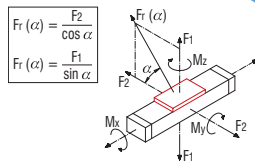

Roller Carriage LW 3		Bearing Carriage WS 4		Bearing Carriage LS 1	
C ₀	2160 N	C ₀	3303 N	C ₀	3508 N
C	4000 N	C	1873 N	C	2105 N
F _{1 stat.}	4320 N	F _{1 stat.}	2821 N	F _{1 stat.}	3549 N
F _{1 dyn.}	3846 N	F _{1 dyn.}	1599 N	F _{1 dyn.}	2130 N
F _{2 stat.}	2160 N	F _{2 stat.}	3303 N	F _{2 stat.}	3508 N
F _{2 dyn.}	4000 N	F _{2 dyn.}	1873 N	F _{2 dyn.}	2105 N
M _{x stat.}	109.5 Nm	M _{x stat.}	29.8 Nm	M _{x stat.}	36.2 Nm
M _{x dyn.}	194.4 Nm	M _{x dyn.}	105.3 Nm	M _{x dyn.}	129.0 Nm
M _{y stat.}	97.2 Nm	M _{y stat.}	123.3 Nm	M _{y stat.}	127.5 Nm
M _{y dyn.}	97.4 Nm	M _{y dyn.}	16.8 Nm	M _{y dyn.}	21.7 Nm
M _{z stat.}	173.0 Nm	M _{z stat.}	59.7 Nm	M _{z stat.}	77.4 Nm
M _{z dyn.}	180.0 Nm	M _{z dyn.}	69.9 Nm	M _{z dyn.}	76.5 Nm

Deflection

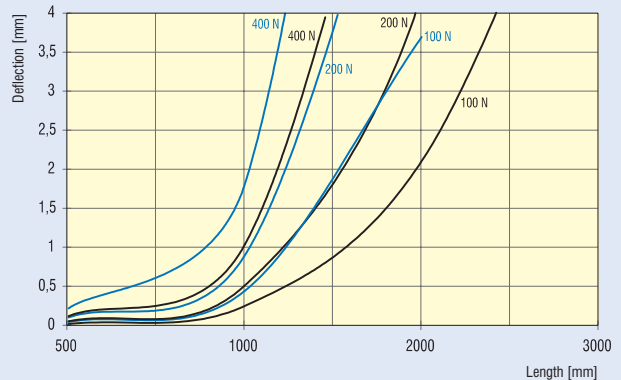
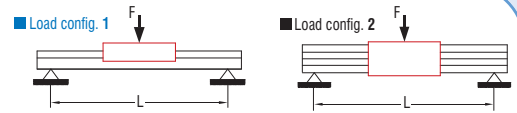

Dimensioned Drawings

* = available upon request

